



The WS4 is a simple and powerful access control system with its own built-in web server. There is no software to install, configuration is done simply via an internet browser.

Very easy to install and to use as all pages are responsive. It offers easy visualization of the status of the system and quick access to different menus directly from the home window.

All the access system can be managed from anywhere in the world. All pages are responsive, which means that you can use your tablet or Smartphone, the pages automatically adapt and the use is very user friendly.



WEBSERVER

WS4-DS-EN-Ve1



Features of the software

- Adaptive web interface format.
- It adapts to the format of your equipment (Responsive Web Design).
- No software to install or download.
- 2,500 users.
- Quick overview of the doors of your installation.
- Possibility to create access name, group, access type, location, locking time, etc...
- The categories define the rights of users.
- 250 categories.
- Entry mode: Card, Finger, PIN Code, Card+PIN Code, WS4 remote app, Remote (RX4W).
- Up to 2 x 12 floors per controller with WS4-RB board (12 relays).
- Each schedule represents a full week, including the weekend and a special case for holidays.
- Define periods during which access is allowed.
- 50 frames.
- Days off can be set. On these dates, the active daily range in the categories will be that for days off.
- Individual days or established dates which are repeated yearly can be set. For example, public holidays.
- License plate recognition with LPR camera with Wiegand output.
- Generate user and events reports and can be exported in CSV format.
- Allows you to see all the events of the installation.
- Persons authorized to connect to the WS4 (via a web browser) and can perform certain actions that depend on their rights.
- A list of 10 operators is available. 1 of the 4 rights can be assigned to each operator. 4 managements rights are available: Total control (Admin), Equipment installation, Access control management, System monitoring.
- Access to the various configuration menus of your system.
- Directly access the help that corresponds to the menu you are configuring.
- The system can be configured to send automatic emails.
- Can be used with all types of device: PC, MAC, Smartphone, iPhone, Tablet, iPad.
- Multilanguage: EN, FR, NL, DE, ES, IT, PT, DK.

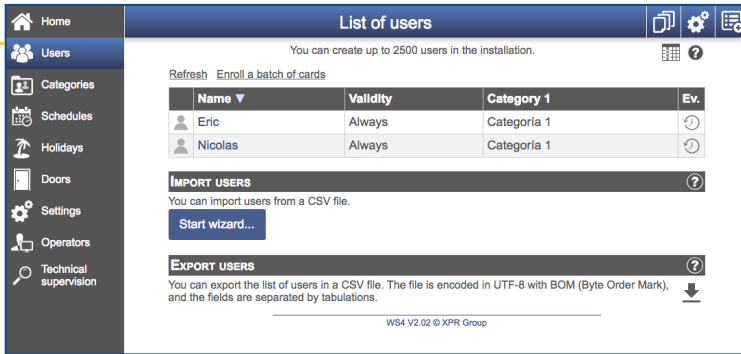

The main menu gives direct access to the user list. Creating and modifying users is then accessible. The list of information displayed may be configured. Users can be imported from an existing CSV file and exported for another use.

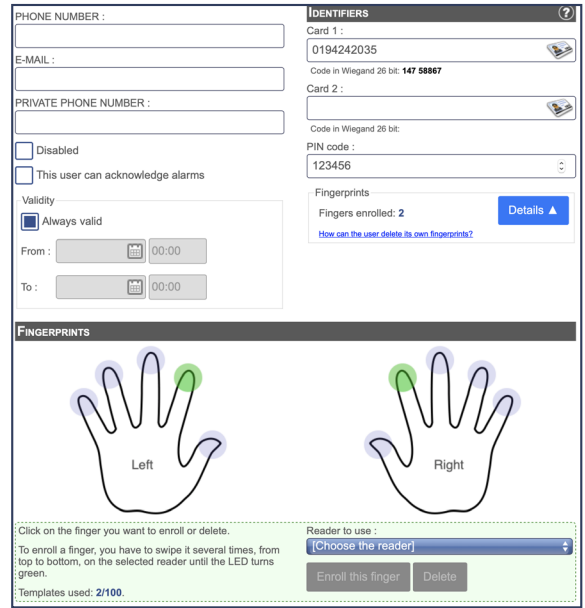

"User" sheet (2,500)

This contains the essential items for identifying users and granting access rights.

- Their surname and name
- Up to 5 open customizable fields
- Their authorized dates and times
- 3 access categories
- Set-up and management of biometric user fingerprints (max 4 fingerprints per user; 100 per installation).
- Their 2 cards and their PIN code

Users may be deactivated in a single click. Activating an option enables a user to deactivate system alarms using their badge.



Defining time frames (50)

Define periods during which access is allowed. There is a time frame for each day of the week and a time frame for days established on the calendar as days off or days on which the company is closed. 3 active periods can be set for each daily range.



10 operators to manage the system

A list of 10 operators is available. 1 of the 4 rights can be assigned to each operator. In addition to temporarily deactivating an operator, 4 management rights are available:

- Total control (Administrator)
- Equipment installation
- Access control management
- System monitoring



Defining categories (250)

This contains the essential items for defining access rights.

- The category name (Access group)
- The doors to which this category gives access
- The time frame during which access is allowed
- 2 override options:
 - blocking during forbidden periods
 - the anti-pass-back function



Days off - Calendar

Days off can be set. On these dates, the active daily range in the categories will be that for days off. Individual days or established dates which are repeated yearly can be set. For example, public holidays.

License plate recognition (LPR)

The WS4 web server allows, among many other functions, the recognition and validation of license plates in connection with an LPR camera with Wiegand output.

A technical monitoring screen

To facilitate operation and maintenance, this screen shows all technical parameters and the status of each external connection of the system.

The screenshot displays the 'Technical supervision' interface. On the left is a navigation menu with options: Home, Users, Categories, Schedules, Holidays, Doors, Settings, Operators, and Technical supervision (selected). The main content area is titled 'Technical supervision' and includes a subtitle: 'This page allows you to quickly view the status of all the inputs and outputs of the system.' Below this are several data tables:

General				
Mains	OK			
Voltage	14.2V			
Box	Closed			
DIP switches	sw1	sw2	sw3	sw4
	OFF	OFF	OFF	OFF
RAM usage	27.5%			

Auxiliary Inputs & Outputs	
Input 1 (Emergency)	OFF
Input 2 (Not used)	OFF
Output 1 (Alarm)	OFF
Output 2 (Attendance)	OFF

Door 1.0 (PORTE)	
Push button	OFF
Door contact	>1 MΩ
Lock relay	OFF
Reader 1	---
Reader 2	---

Door 2.0 (PORTE 3)	
Push button	OFF
Door contact	OFF (door OPENED)
Lock relay	OFF
Reader 1	---
Reader 2	---

Door 1.1 (PORTE 2)	
Push button	OFF
Door contact	>1 MΩ
Lock relay	OFF
Reader 1	---
Reader 2	---

Door 2.1 (PORTE 4)	
Push button	OFF
Door contact	OFF (door closed)
Lock relay	OFF
Reader 1	---
Reader 2	---

General information

- Power supply status
- Power supply voltage input on the WS4
- The status of the protective contact of the casing
- The status of the configuration dip-switches
- Internal memory usage status

For each door

- The status of the push button
- The status of the door contact
- The control status of the locking system
- Connection status with readers

For inputs and outputs

- The status of the two inputs
- The status of the two outputs



Flexible technical configuration

The configuration screen provides access to various features. System information is displayed on this screen.

- Network configuration
- Date and time
- "System" options
- Wiegand readers
- Auxiliary inputs and outputs
- "User" options
- Backup and update
- Mail service configuration
- Restore a backup
- Firmware update
- System log
- Alarm function

Find us on www.xprgroup.com

We invite you to visit our website to obtain more information about our products.



All product specifications are subject to change without notice.